



# CdG Newsletter – Issue #1

## Message from the CdG President



Dear families and friends of LFIPV,

On behalf of the Comité de Gestion (CdG), thank you to everyone who attended or sent proxies for our Annual General Meeting held on Thursday, 9 October 2025. With 34 members present and 55 proxies, the quorum was reached, and the 2026 budget was successfully approved.

While we were pleased to reach quorum, we also recognise that attendance in person was lower than hoped. As a community school, your presence and participation truly matter. We warmly encourage more parents to join future meetings and contribute to decision-making.

To help make our AGMs more accessible, we now provide:

- live translation services,
- PowerPoint and documents in English, Chinese, and French,
- and clearer supporting materials.

Your ongoing trust and participation are what make our governance model strong. Together with our teaching team, AEFÉ representatives, and parent volunteers, we continue to ensure that our school remains a place of excellence, inclusion, and community spirit.

Wishing everyone a safe and happy end of year and see you in 2026!

— Nicolas Monvoisin, Président, CdG

## AGM Highlights

This year’s AGM covered many important updates for our community. Key topics included:

- An overview of the AEFÉ network and the school’s renewed accreditation.
- Enrolment trends showing almost 100 more students over six years.
- Presentation of the 2026 budget, including operations, personnel, and investments.
- A detailed update on the Extension Project.
- Discussions on sustainability and future solar integration.
- A Q&A session on safety, teaching spaces, and future reorganisations.

The meeting reflected strong cooperation between leadership, staff, and parents — and a shared commitment to continuous improvement.

## 2026 Budget Overview

The 2026 budget was developed with careful attention to expected enrolment changes, staffing needs, and inflationary pressures.

- Key figures:
- **Operating expenses:** down 7% (58.3M VT vs 62.5M VT in 2025)
  - **Personnel expenses:** up 1% (347.0M VT vs 343.5M VT in 2025)
  - **Investments:** focused on energy upgrades, new equipment, and the school extension

Savings in operating costs helped offset increases in personnel expenses, maintaining financial stability.

To meet AEFÉ standards, ensure consistent enrolment, and manage inflation, a **5% increase in tuition fees** was approved across all levels.

# Extension Project Update

The extension project represents a major step in LFIPV's development — a new two-level building dedicated to science, technology, and student learning.

Ground floor includes:

- 1 school life office
- Multipurpose room for high school students / meetings
- Technology room
- 3 laboratories
- 3 storage rooms
- Student toilets
- Accessibility ramps



First floor includes:

- 6 classrooms
- Meeting room
- Computer lab with server space
- Student and teacher washrooms

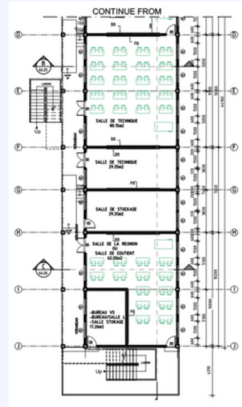
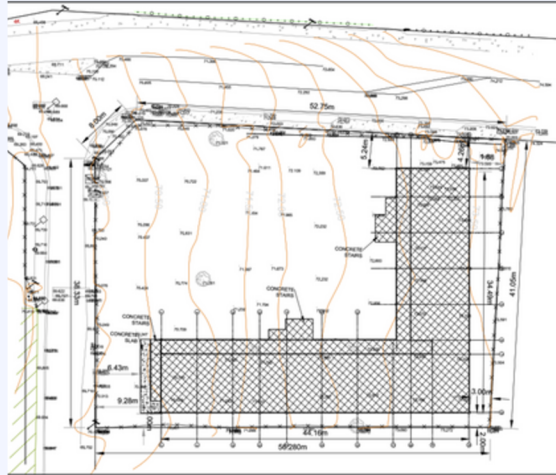

Timeline:

- End of 2025: Finalisation of architectural and structural plans
- Early 2026: Financing secured & call for tenders
- 2026: Construction
- Target opening: Start of the 2028 school year

The design preserves green space and includes a central faré for shade and student gathering. Parking will not be built on the site, but discussions with public works are ongoing to ensure safe access and minimal crossing for students.

## Project Management Appointment

The CdG has appointed Cyrille Mainguy, MCEPM (Mainguy Construction Engineering Project Management) to manage the extension project. This decision was made during the presentation of the architectural plans, following a formal quotation process and comparative review.

MCEPM was selected based on:

- the quality of the work already provided, including architectural support,
- strong local experience, and
- a significantly discounted rate offered for the project.

This appointment was validated collectively by the CdG and is formally recorded in the meeting minutes.



# Key Questions from Parents at the AG

- School supplies: Despite a 13% reduction, this will not affect quality — early pre-ordering allowed better budgeting.
- Sustainability: The new building is planned to include solar power and meet higher environmental standards.
- Tuition and negotiations: Salary negotiations are ongoing, and the budget includes a provision for this.
- Safety and circulation when the new site will open: Timetable adjustments and site organisation will minimise student movement between buildings.
- Change of building plans after December 2024 earthquake: Since the review of the plan move from 3 storages to 2 storages, the library (CDI) originally planned on the ground floor has been removed.
- Library (CDI): While the new building will not include a CDI, the current CDI will be expanded once internal spaces are reorganised.

All votes were cast in favour of the 2026 budget (0 against, 1 abstention).

## Community Acknowledgements



The CdG warmly thanks:

- Proviseur Francis Baquié, Directeur Vincent Baraud, and RAF Lavinia Russet for their leadership and partnership.
- Representatives of the Embassy of France: COCAC Yannick Le Roux and Consule Delphine Monnier for their ongoing support.
- Parents and families for their engagement and trust.

Together, we ensure LFIPV remains a place where children learn in a supportive, multicultural environment.

## Looking Ahead to 2026



- Launch of tender process for the Extension Project
- Recruitment of six new teachers (four arriving in February, two in August)
- Strengthening of anti-bullying initiatives
- Continued development of the multilingual language policy
- Improved CdG communication with families — starting with this newsletter

We look forward to keeping you informed as the year unfolds.



## Stay Connected

For questions, feedback, or suggestions for future newsletters, please contact:  
Adam Trau at: [trau22@gmail.com](mailto:trau22@gmail.com)